

UL-68166 | ERGO HANDLES

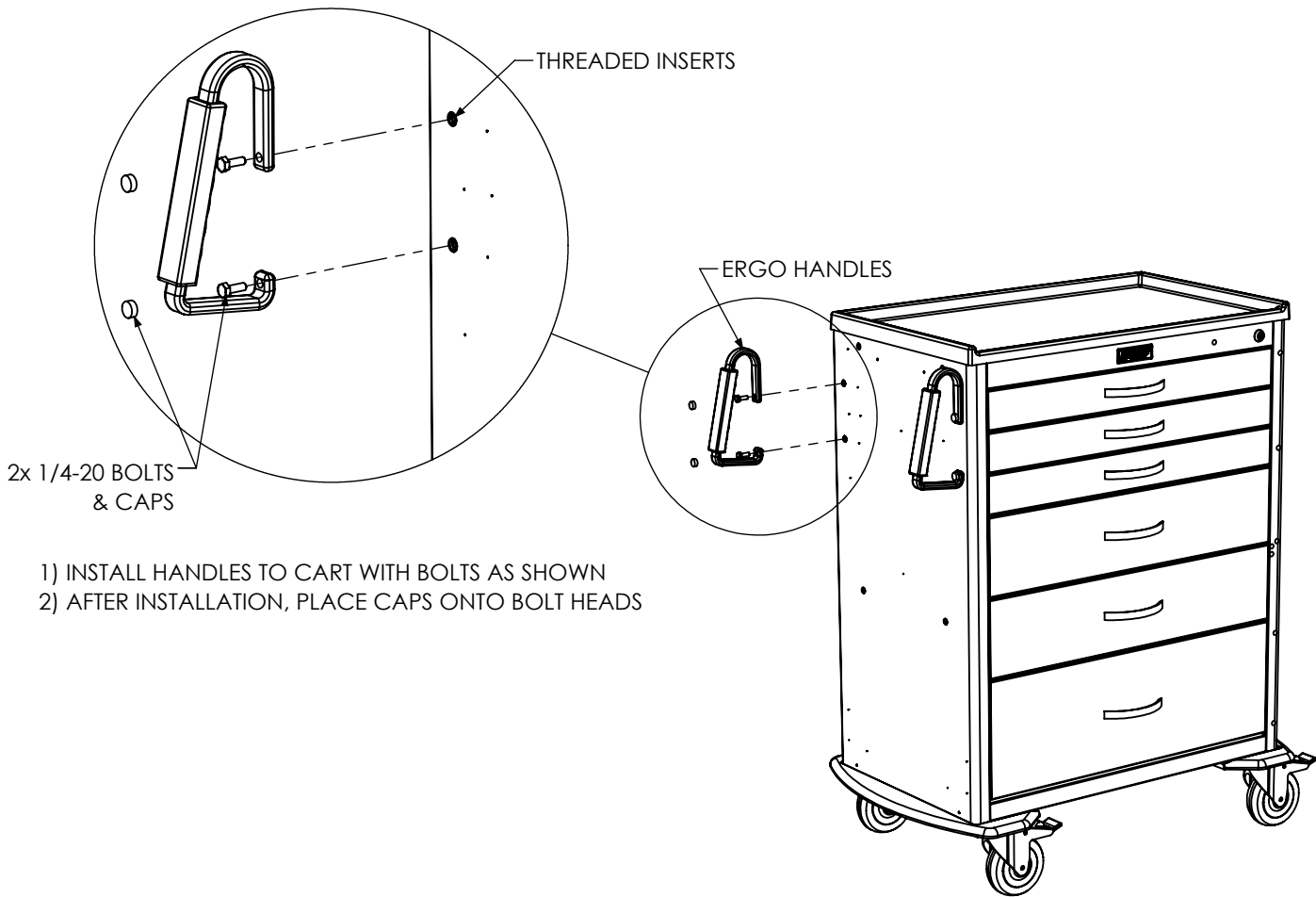

- 1) INSTALL HANDLES TO CART WITH BOLTS AS SHOWN
2) AFTER INSTALLATION, PLACE CAPS ONTO BOLT HEADS

LEFT SIDE FACTORY SET FOR HANDLE INSTALL

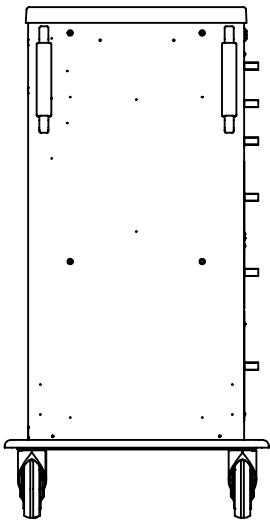

RIGHT SIDE OPTIONAL
(HOLES WILL NEED TO BE DRILLED, & INSERTS ADDED_

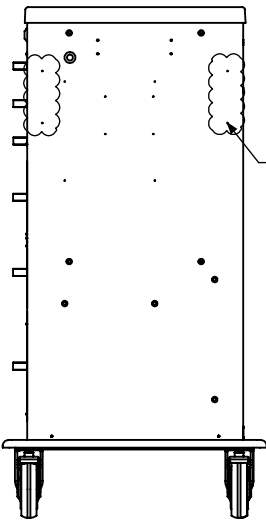
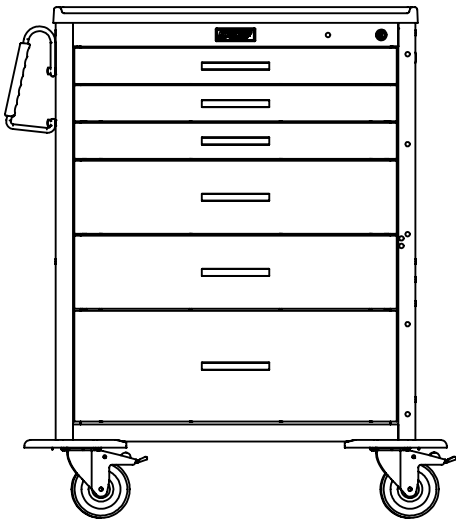

DRILL 4X PILOT HOLES TO 25/64"
*CONTACT HARLOFF FOR ADDITIONAL REQUIRED HARDWARE

TOOLS REQUIRED:



7/16" WRENCH



25/64" DRILL BIT
(OPTIONAL)



1-800-433-4064
MEDICALSALES@HARLOFF.COM

PART NO.	UL-68166	DESCRIPTION	ERGO HANDLE INSTALL	REV 0
----------	----------	-------------	---------------------	----------